

STEP 1 INSERT NANO SIM CARD

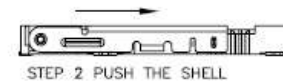

STEP 2 PUSH THE SHELL



STEP 3 FINISH

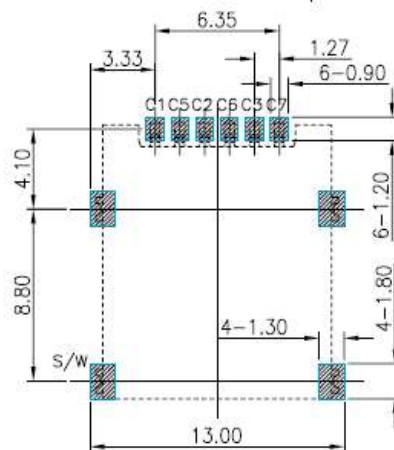
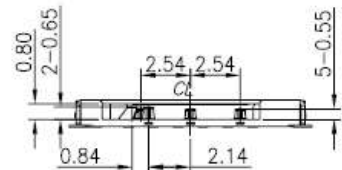

RECOMMENDED PCB LAYOUT
TOLERANCE ± 0.05
SMT SOLDER AREA

Circuit Diagram for Card Detect Switch

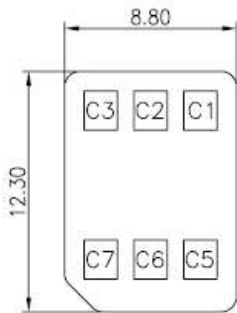
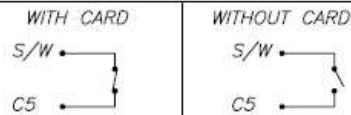

PIN NO.	PIN NAME
C1	VCC
C2	RST
C3	CLK
C5	GND
C6	VPP
C7	I/O
S/W	Switch Pin

NOTES:

1. MATERIAL:

- 1.1 Housing: High Temperature Thermoplastic UL94V-0; Color Black.
- 1.2 Terminal: Copper Alloy, $T=0.10\text{mm}$.
- 1.3 Shell: Stainless Steel, $T=0.20\text{mm}$.

2. FINISH:

- 2.1 Terminal: Plated Gold on the Contact Area and Solder Tails
- 2.2 Peg: Plated Gold on the Solder Tails.

3. SPECIALITY:

- 3.1 Rated current: 0.5A
- 3.2 Rated voltage: 50V
- 3.3 Contact Resistance: 80m Ω MAX
- 3.4 Insulation Resistance: 100M Ω MIN 100V DC
- 3.5 Dielectric withstanding voltage: 100V AC.
- 3.6 Solder ability: 245 $\pm 5^\circ\text{C}$, 5 $\pm 0.5\text{s}$.
- 3.7 Operating condition: Temperature: $-30^\circ\text{C} \sim +80^\circ\text{C}$
Humidity: 80% R.H MAX

REYAX TECHNOLOGY CO., LTD.			TOLERANCE UNSPECIFIED	± 0.10
TITLE:	MICRO-SIM 1.5H	UNIT	mm	
PART NUMBER:	RYSC00N	SCALE	1:1	
DRAWING NUMBER:		SHEET	1/1	